

Guide Map

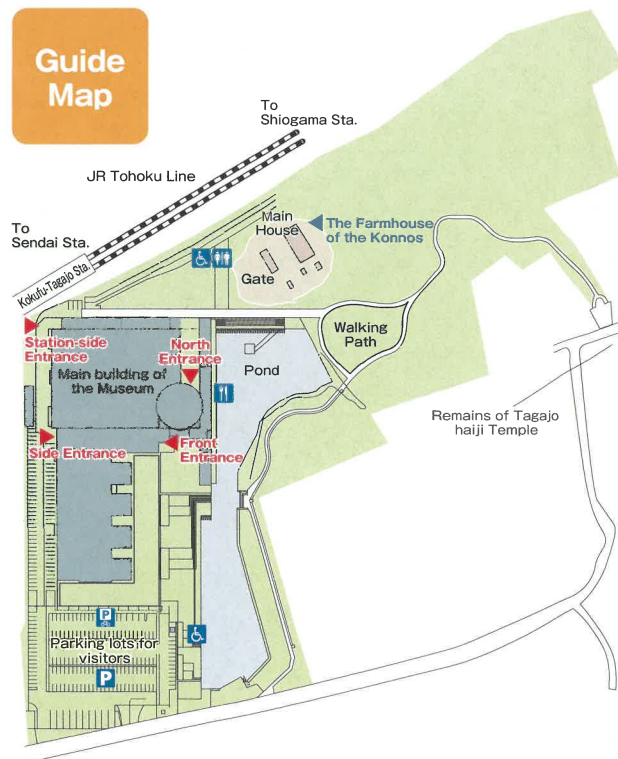

The Farmhouse of the Konnos (Admission Free)

Built in the middle of the Edo period, originally located in Kitakami-Machi, Ishinomaki City in Miyagi Pref., and removed to this museum.

You can get a glimpse of farmer's lifestyle in those days.



General Information

Open 9:30 a.m.-5:00 p.m. (entry closes at 4:30)

Closed Every Monday (except national holidays),
December 29-January 4
Also occasionally closed on other days

Admission Fee

	Adults	Elementary/J.H.S/H.S. students
Individual	¥ 460	Free
Group (20 or more)	¥ 360	

*Call for information on special exhibition fees.

Area Map

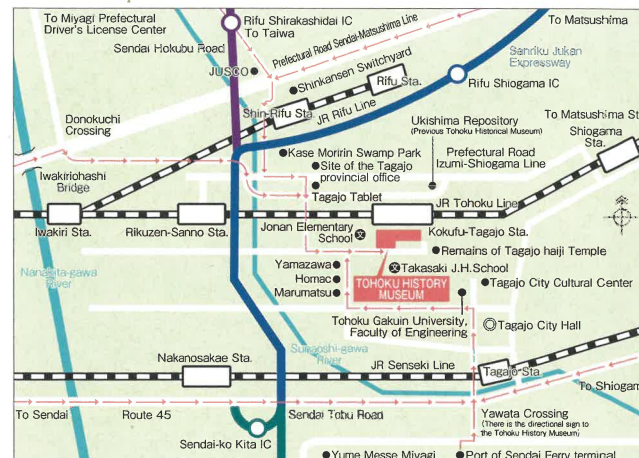

Access

- **Via JR Tohoku Line**
Approximately 14 minutes from Sendai Station to Kokufu-Tagajo Station.
About 1 minute on foot.
- **Via JR Senseki Line**
Approximately 21 minutes from Sendai Station to Tagajo Station.
About 10 minutes by taxi or 25 minutes on foot.
- **By car**
 - From Sendai Tobu Road
Approximately 10 minutes from Sendai-ko Kita Interchange to the museum.
Free parking available for 191 cars

Contact

1-22-1 Takasaki, Tagajo, Miyagi 985-0862 Japan

東北歴史博物館
TOHOKU HISTORY MUSEUM

Tel. +81-(0) 22-368-0101 Fax. +81-(0) 22-368-0103

URL: <http://www.thm.pref.miyagi.jp/>

e-mail: thm-service@pref.miyagi.jp

東北歴史博物館

TOHOKU HISTORY MUSEUM



1F

■ Fee required

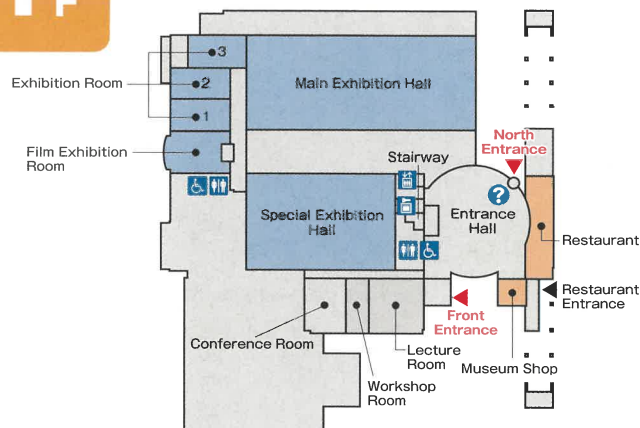

Main Exhibition Hall

Exhibits on nine periods ranging from the Paleolithic Age to the Modern Age display the history of Tohoku. An advanced exhibition is arranged according to three characteristic features of Tohoku.

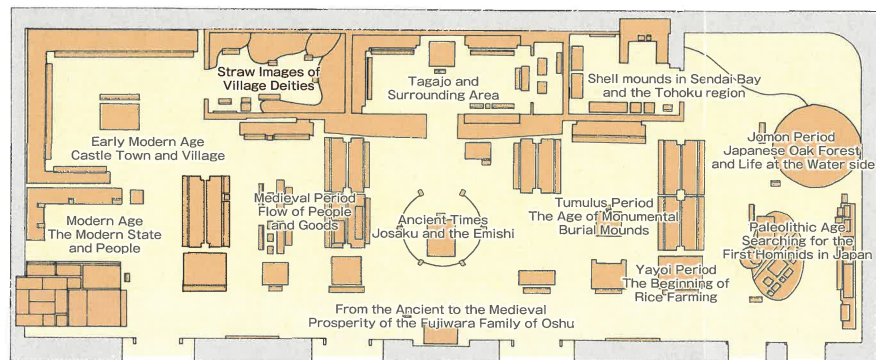

Special Exhibition Hall

Special or planned exhibits are held a few times a year.



Film Exhibition Room

This room shows films on the festivals and folk art of the Tohoku district. Screenings are twice a day at 11:00 a.m. and 1:00 p.m.



Exhibition Rooms 1-3

Visitors can view historical objects of the Tohoku district close-up, displayed from the museum's holdings.



3F

■ Free-of-charge

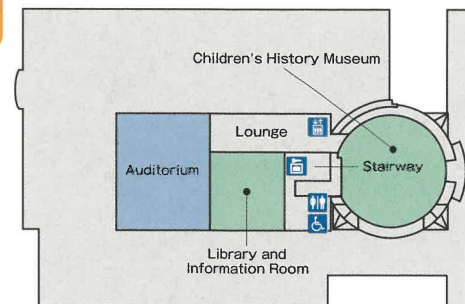

Children's History Museum

Both school children and adults can learn history by using the resources in this room.



- **Work Tables**
Try using a stone knife or weaving cloth as they did in the jomon period!
- **Personal Computer Land**
Learn about the history of Tohoku and about the museum through computers!
- **Interactive Theater**
Watch various films on the history of Tohoku in our multiple-screen, dome-shaped theater!

Library and Information Room

Various reference books and videos on the history and culture of the Tohoku district are available. Information on the materials owned by the museum can be accessed via personal computers.



- **Number of Printed Materials:**
approximately 100,000 volumes
- **Number of Visual Materials:**
800
- **Number of computers:** 5
- **Photocopy service is available**
for copying materials.

Auditorium

This facility has a seating capacity of 294 and also available for rental service. Inquire for further details.

& Sun. restaurant serving



Museum Shop

Books, original products and so on are sold here. Books published by the museum (such as illustrated history books) are also available for purchase and may be shipped upon request. Please inquire for further information.

Hours: 9:30 a.m.-5:00 p.m.
Closed on Mondays
Tel. +81-(0)22-389-0931

Tel +81-(0)22-368-3876